

DESIGN NOTES:

1. CONCRETE - 6,000 PSI, 28 DAYS
2. REINFORCING STEEL CONFORMS TO LATEST ASTM A615
3. H-20 DESIGN LOADING PER AASHTO HS-20-44

HEAVIEST PICK = 12,458 LBS.

STORAGE VOLUME CALCULATIONS

RETAIN IT INFILTRATION SYSTEM (4' ID HEIGHT STORAGE VOLUME)
 USE: "1" - (18) X 230.94 CUFT PER UNIT = 4,156.92 CUFT
 "2", "4", "5" - (22) X 223.39 CUFT PER UNIT = 4,914.58 CUFT
 "3A", "3B", "3C" - (4) X 215.83 CUFT PER UNIT = 863.32 CUFT

TOTAL MODULES = 44 TOTAL MODULE STORAGE = 9,934.82 CUFT

AVAILABLE STONE STORAGE

BASE; 24" THICK
 (44 x 64' x 2') x 30% = 1,689.6 CUFT
 PERIMETER; 12" THICK
 (244' x 6.67' x 1') x 30% = 488.24 CUFT
 TOTAL STONE STORAGE (@ 30%) = 2,177.84 CUFT

TOTAL SYSTEM STORAGE = 12,112.66 CUFT

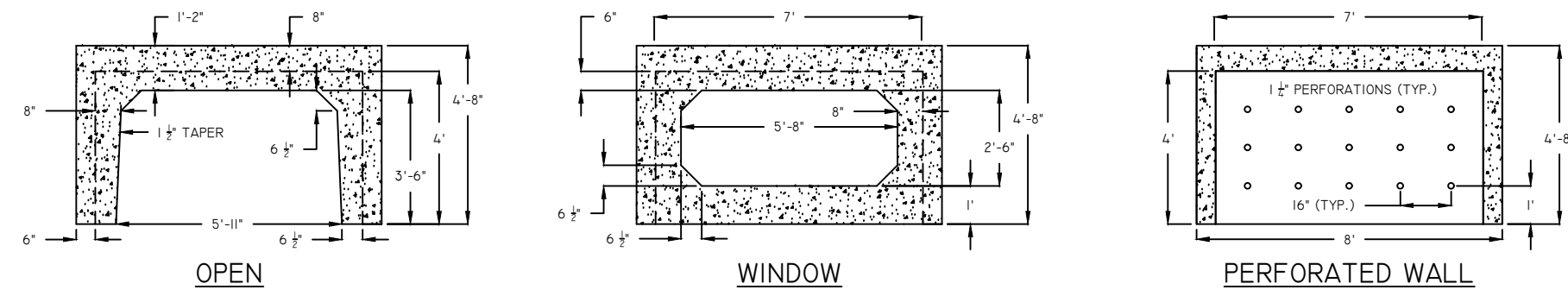

TYPICAL 4' MODULE DIMENSIONS

SCHEMATIC LAYOUT

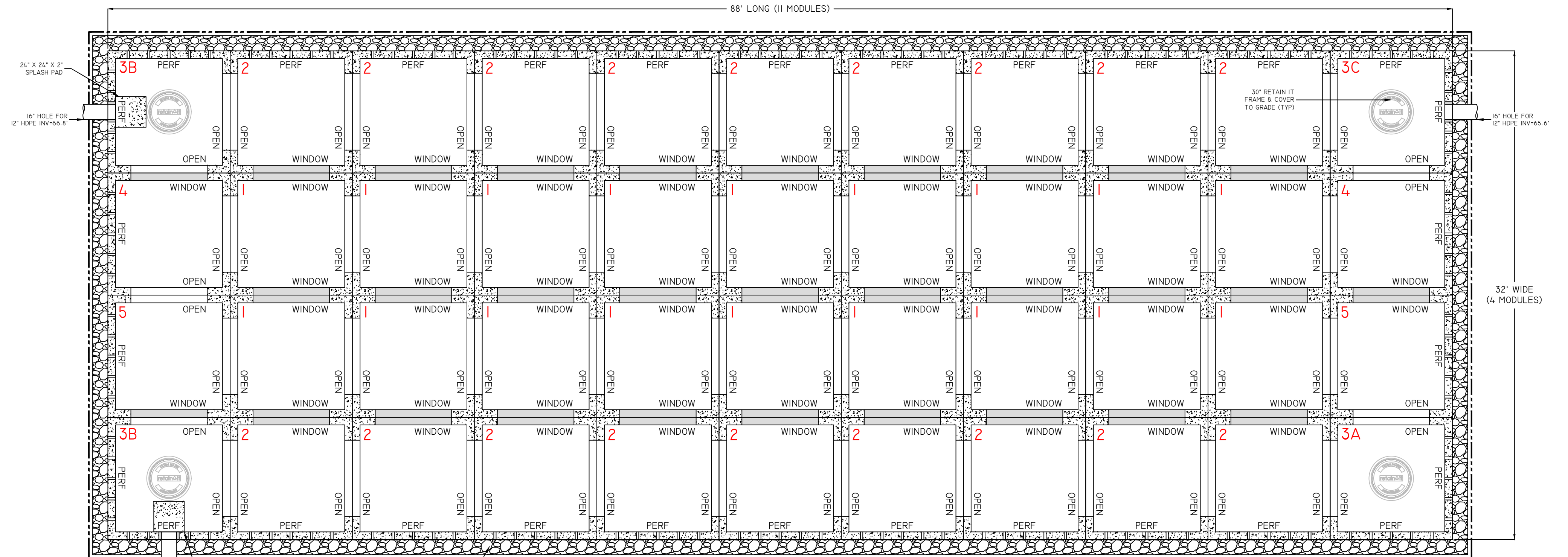

PLAN VIEW

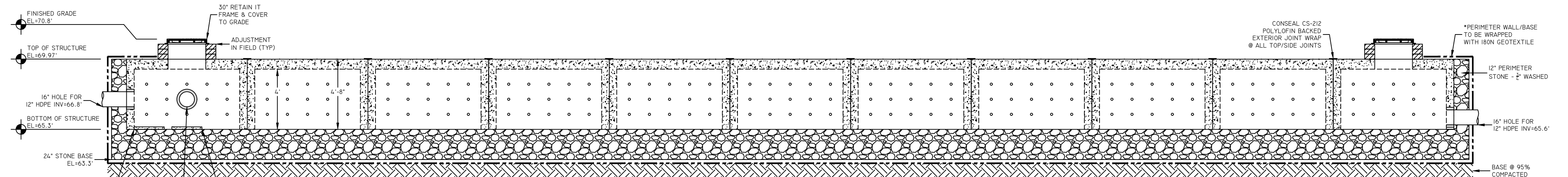

ELEVATION

- *GEOTEXTILE LAYERS**
- 180N GEOTEXTILE (SYSTEM WALLS & BASE PLUS SEDIMENTATION ROW WALLS)

MIRAFI MANUFACTURED BY TENCATE GEOSYNTHETICS OR APPROVED EQUAL
 365 SOUTH HOLLAND DRIVE
 PENDERGRASS, GA 30567

ANY MODIFICATIONS TO THIS DOCUMENT WITHOUT THE WRITTEN CONSENT OF ARROW CONCRETE PRODUCTS SHALL RENDER IT INVALID AND UNUSABLE.

APPROVAL:
 SIGNATURE _____ DATE _____

No.	Revision/Issue	Date
3	CHANGED OUTLET ELEVATION & PIPE SIZE	2-5-20
2	MODULE SIZE CHANGE	1-14-20
1	SUBMITTAL OF REVIEW	12-31-19
No.	Revision/Issue	Date

DWG #	19-49444	Sheet	2 OF 2
Date	12/31/19		
Scale	N.T.S.		